

MMY Churches St. Croix Lutheran High School Chapel

Architect

Kodet Architectural Group

Contractor

RJM Construction

Location

West St. Paul, MN

Awards

2006 AIA Minnesota Honor Award
Preservation Award

Open and airy chapel created with innovative engineering.

The structural tectonics of this building are defined by a space frame supported by four slender columns, a visually projecting free-standing cross and planar walls that open to the outside with tall floor to ceiling windows. This architectural endeavor gave us our chance to shine.

The space frame was analyzed to be as open as possible. It takes advantage of thin rod tension members and custom H-shaped compression members. The detailing for the frame was custom engineered along with the architect to create visually interesting details that were also easy to construct.

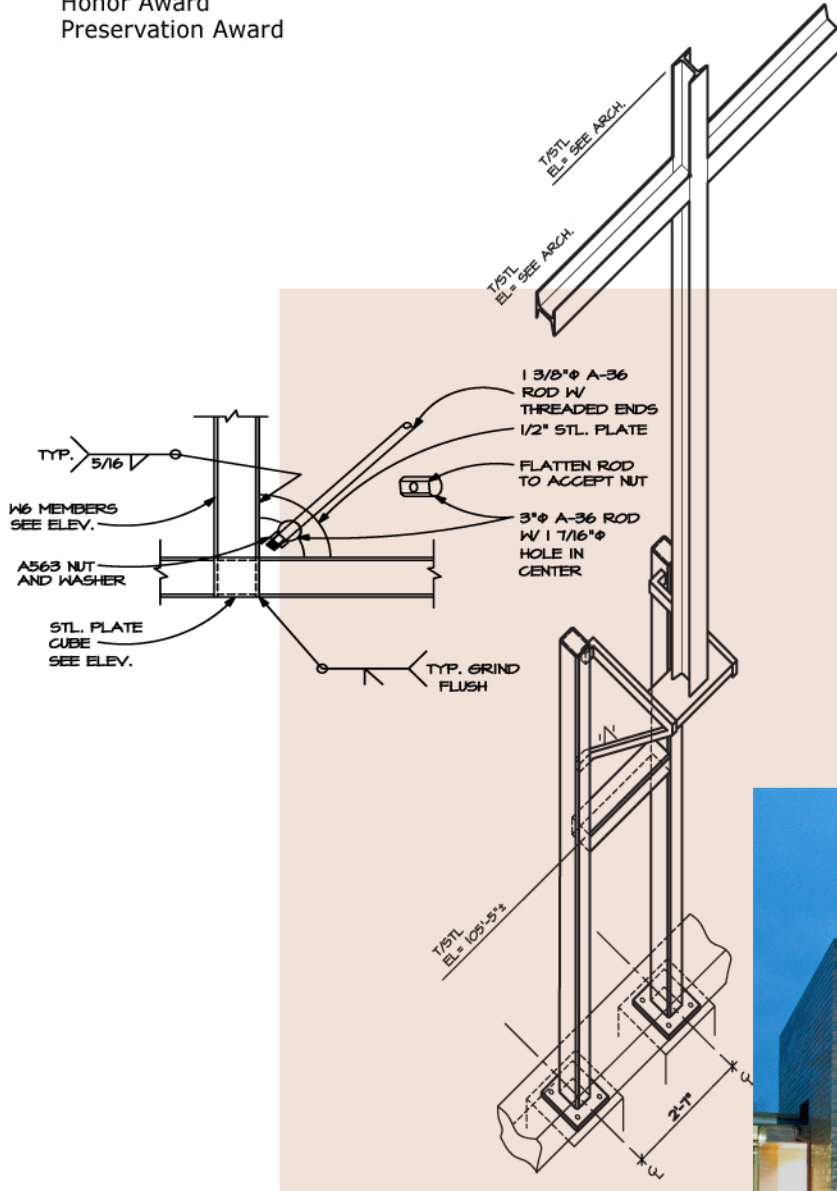

See the latest projects at
www.MattsonMacdonald.com

